



**INDOOR ICE MERCHANDISER**

**MODEL 100**



**We're With You Every  
*Degree* Of The Way**





# INDOOR ICE MERCHANDISER

## MODEL 100

### PRODUCT SPECIFICATIONS

#### Standard Model Numbers

Auto Defrost – R404a:	L100UAGE
Cold Wall – R404a:	L100UCGE
Auto Defrost – R290:	L100UAGP
Cold Wall – R290:	L100UCGP

#### Dimensions & Capacities

7 lb. Bags - Auto Defrost:	260
20 lb. Bags - Auto Defrost:	100
7 lb. Bags - Cold Wall:	290
20 lb. Bags - Cold Wall:	110
Approx. Interior Cubic Feet:	100
Dimensions (W"xD"xH"):	94 x 35.5 x 76.5
Door Size (W"x H"):	28 x 47

#### Operating Temperature

(X°F - X°F):	16 -24
Control:	Electronic Control

#### Product Weight

Auto Defrost (lbs.):	655
Cold Wall (lbs.):	605

#### Electrical

Voltage (V/Hz):	115 / 60
Min. Circuit Required (Amps):	15
Auto Defrost (Amps):	10
Cold Wall (Amps):	10
230V/50Hz Available:	Upon Request

#### Other

Compressor (HP):	1/2
Refrigerant:	R404a, R290
Certifications:	UL, cUL, CE
DOE Compliant:	Yes
CARB Compliant:	Upon Request
NSF Available:	Upon Request

1. Height Includes Compressor
2. Add 3" to Depth for Condensate Evaporator Pan
3. Add 3" to Depth for Low Profile Raceway
4. Add 3.5" to Depth for Glass Door & Handle
5. Add 3" to Depth for Upright Solid Door & Handle
6. Add 1" to Depth for Slant Solid Door & Handle
7. Merchandiser storage capacities are approximate & may vary due to type of ice, bag size, and methods of loading.

### DIMENSIONAL DRAWINGS

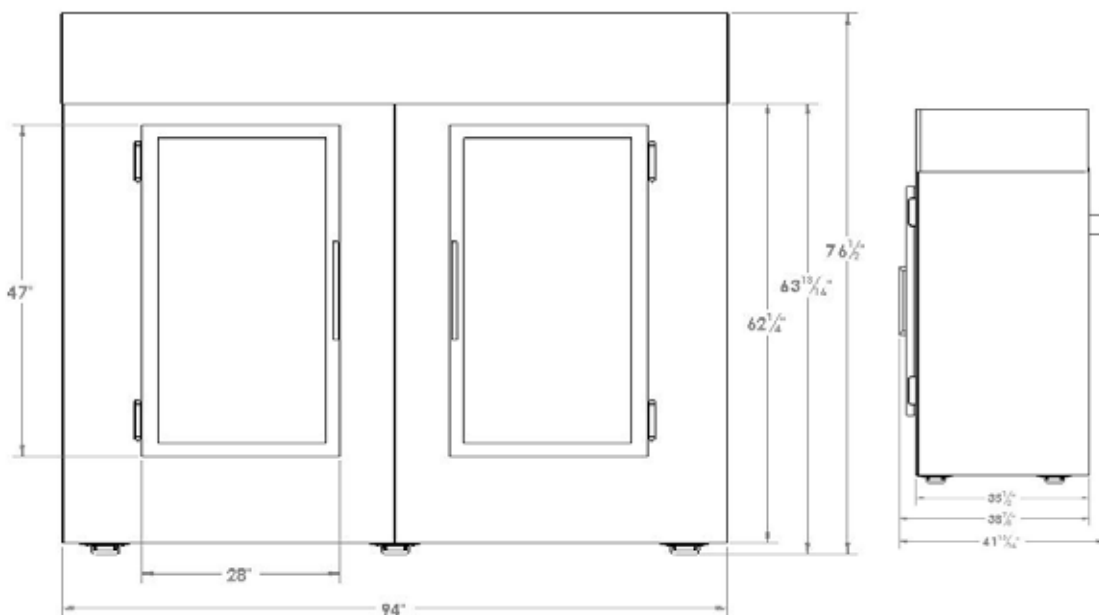

### VIDEO LIBRARY [leerinc.com/video-library](http://leerinc.com/video-library)

